

gala

Reference G3931000
Description Basin mixer
Collection BALANCE



TECHNICAL SPECIFICATIONS

- Single lever mixer with cold start
- Eco-friendly cartridge with two-step opening
- Flow restrictor to 5 l/min included

Ceramic discs cartridge $\varnothing 40$ mm

Anti-vandal aerator with limescale protection and integrated filter against particles

3/8" flexible connection hoses included

Installation with up-down valve

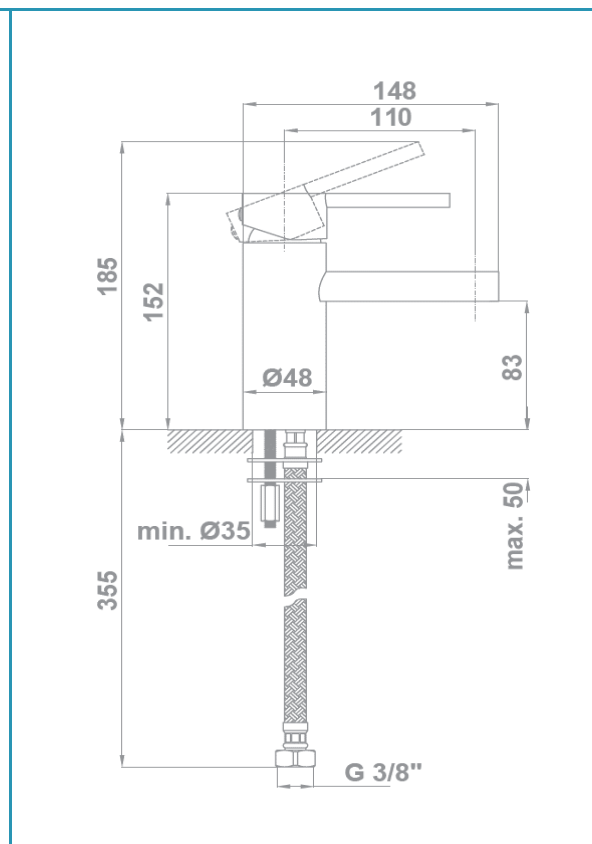

FLOW RATE

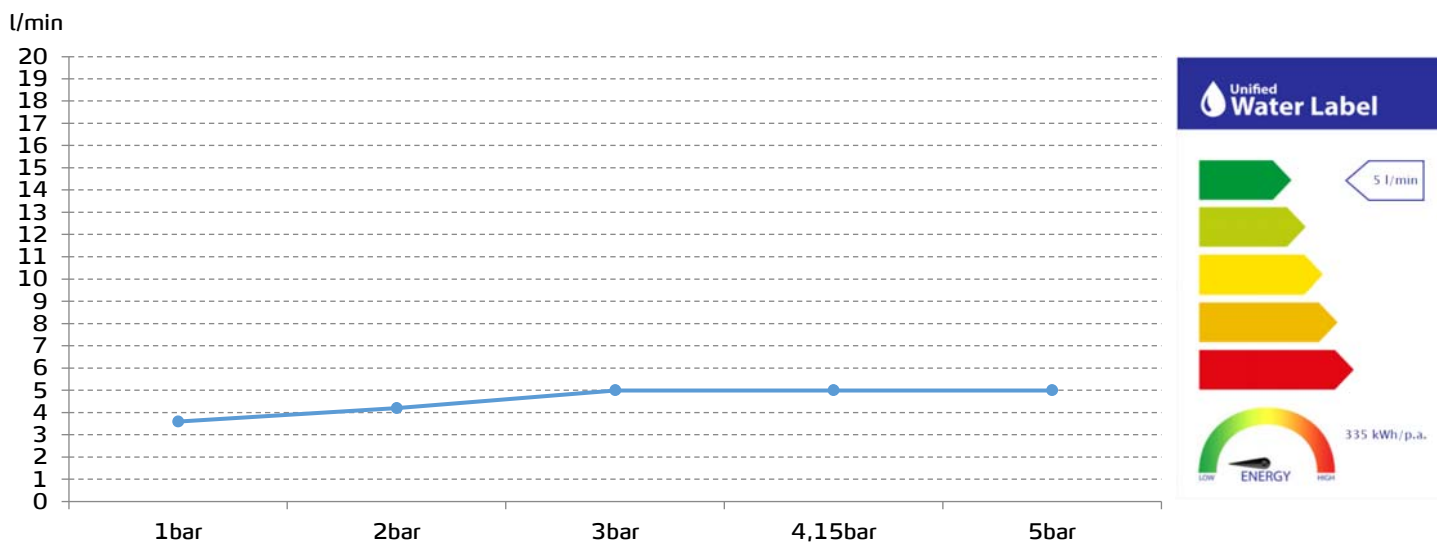

Data measured in maximum flow position with mixed water